

PRODUCT DIMENSIONS

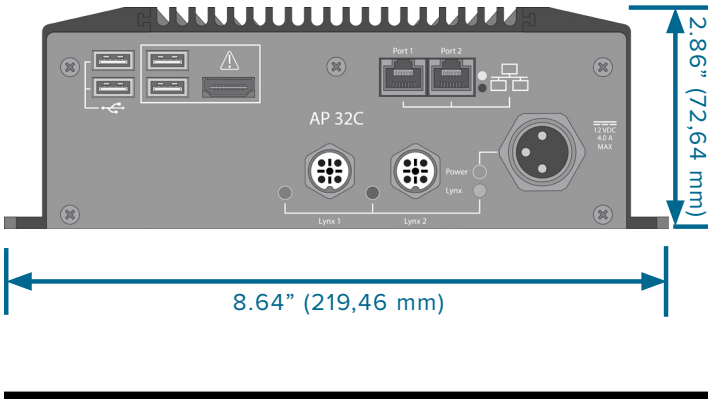

SENSOR PRECHECK



The Sensor PreCheck provides testing of up to 30 Lynx™ cavity pressure sensors simultaneously, including the automatic testing of strain gage sensors for lynx communication, zero offset, and broken wire/failed gage tests; automatic testing of piezoelectric sensors for lynx communication and drift tests; manual testing of strain gage sensors for basic force detection; and manual testing of piezoelectric sensors for basic force detection.

TECHNICAL SPECIFICATIONS

HARDWARE

Included Power Supply	12 V DC
Lynx Premium Cable	CE-LX5-W-.5M
Max. Lynx Sensors	30
Tablet	Samsung Galaxy with USB cable

APPLICATION

OS Requirements	Android 4.4 KitKat or Later
Memory Required	10 MB

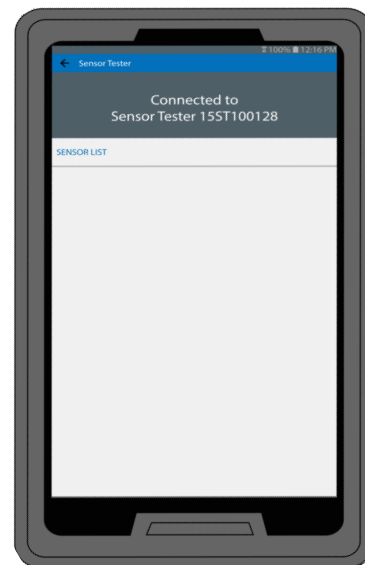

OPERATION

① **NOTES** *The tablet must be physically near the AP 32C and sensors being tested for optimal performance.*

1. Connect power to power supply and AP 32C; the power indicator light will be on if power is on.
2. Attach lynx cable to lynx input on AP 32C and sensor(s).
3. Open application on tablet and select the Sensor PreCheck to connect (3 at right).

① **NOTES** *WiFi must be enabled on the tablet to connect with the AP 32C.*

4. Begin an automated test (4 at right).
5. Force test the sensor(s); end the force test when complete (5 at right).

① **NOTES** *The application will time out if no signal is received from the sensor in a specific length of time; be ready to apply force to sensor(s).*

For complete operating instructions, troubleshooting, and warranty information refer to the Sensor PreCheck User Guide—available online for download at www.rjginc.com.

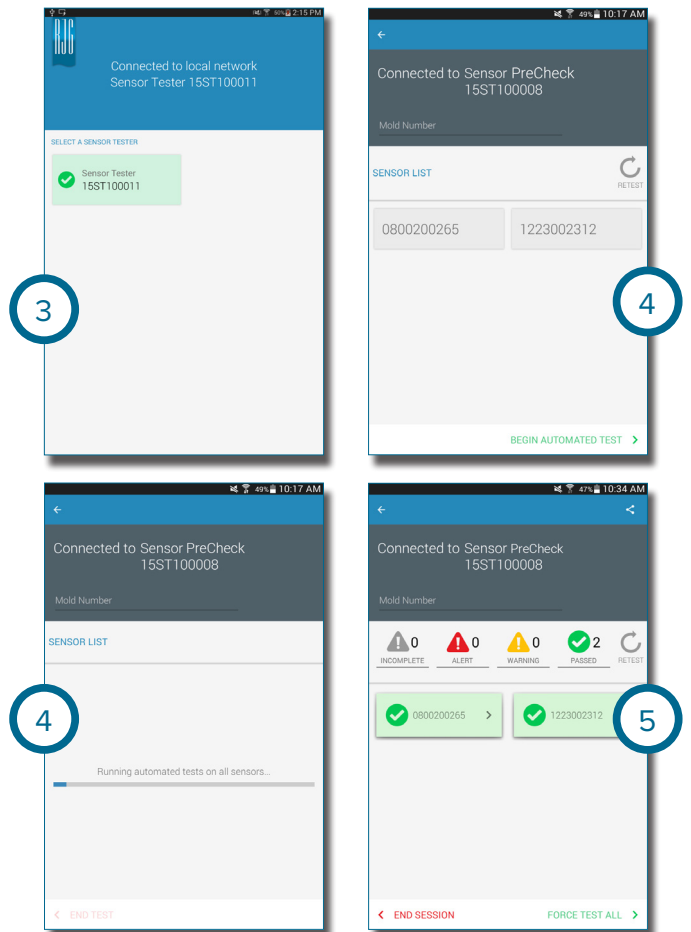

- | | |
|---|-----------------------|
| A | USB Port ¹ |
| B | Power Port |
| C | Power Indicator Light |
| D | Lynx Port |
| E | Tablet |

